

REVISIONS			
REV	DESCRIPTION	DATE	APPROVED
A	RE-DRAWN & RELEASED	1/98	1/98
B	UPDATE DWG	9/07	9/07

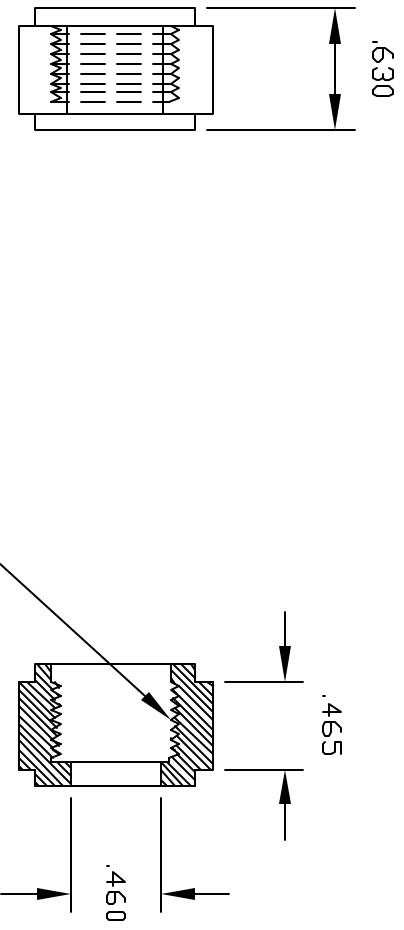

TO MATE WITH THOGUS INSERT ADAPTER
SNA6, 3/8" INSERT

CONTROLLED DOCUMENT
ONLY IF IN RED

CONFIDENTIAL
THIS PRINT AND THE SPECIFICATIONS ARE THE PROPERTY OF THOGUS PRODUCTS COMPANY AND HAVE BEEN ISSUED WITH THE UNDERSTANDING THAT ALL INFORMATION CONTAINED HEREIN IS UNCLASSIFIED AND WILL BE RETURNED UPON REQUEST.

UNLESS OTHERWISE SPECIFIED DIMENSIONS ARE IN INCHES		TOLERANCES	
DECIMAL	FRACTIONS	ANGLES	HOLES
XX +/- .05	+/-.05	+/-.05	XX +/- .015
DRAWN	DATE	Part Number	
NM	1/98	3/8 NPT FEMALE	SWIVEL NUT
DESIGNED		THOGUS 33490 PIN DAK PARKWAY	
SNGN		PRODUCTS AYOON LAKE OHIO 44012	
MATERIAL		Part Number	REV
NYLON		SNA6/N	B
		SHEET 1	of 1