

REVISIONS				
ZINC	REV	DESCRIPTION	DATE	APPROVED
	A	REDRAWN & RELEASED	1/98	1/98

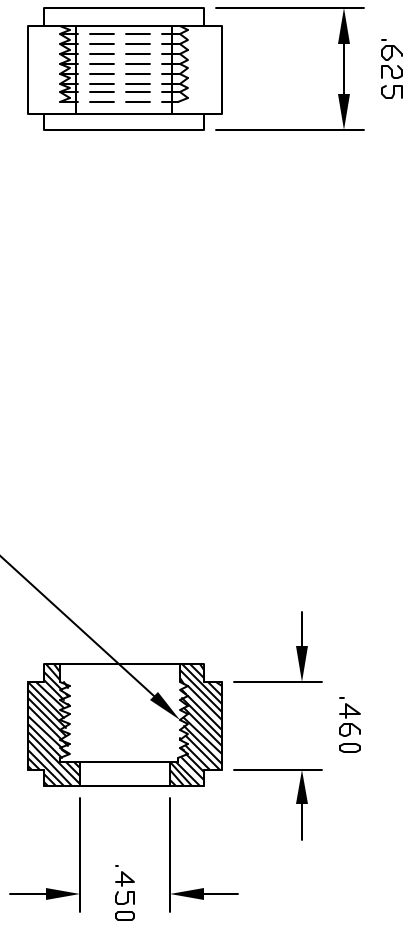

FEMALE 3/8" NPT
 TO MATE WITH THOGUS INSERT ADAPTER
 SNA6, 3/8" INSERT

CONTROLLED DOCUMENT
 ONLY IF IN RED

CONFIDENTIAL
 THIS PRINT AND THE SPECIFICATIONS ARE THE PROPERTY OF THOGUS PRODUCTS COMPANY AND HAVE BEEN ISSUED WITH THE UNDERSTANDING THAT ALL INFORMATION CONTAINED HEREIN IS UNCLASSIFIED AND THE RIGHTS OF THE MANUFACTURER FOR OTHERS AND WILL BE RETURNED UPON REQUEST.

UNLESS OTHERWISE SPECIFIED DIMENSIONS ARE IN INCHES		Part Number	3/8 NPT FEMALE SWIVEL NUT
DECIMAL TOLERANCES	±.015	THOGUS PRODUCTS	33490 PIN DAK PARKWAY AYDON LAKE OHIO 44012
XX +/- .015		Part Number	SNA6/PPB
XXX +/- .015		Material	POLYPROPYLENE BLACK
DRAWN	NM	DATE	1/98
DESIGNED		SCALE	1:1
MATERIAL		SHEET	1 of 1
REV		REV	A

NOT TO BE USED FOR OTHER THAN ORIGINAL DESIGN